



SUHAIL

مصنع سهيل للمصبوكات المعدنية
SUHAIL FACTORY FOR METAL CASTINGS

CATALOGUE 2022

SUHAIL FACTORY FOR METAL CASTINGS

INDEX

PROFILE

FACILITIES

CERTIFICATIONS

MATERIAL SPECIFICATIONS

MANHOLE COVERS

MANHOLE PRODUCT SELECTOR

CIRCULAR COVERS AND FRAMES

SQUARE/RECTANGULAR COVERS

GULLY GRATES AND FRAMES

CHANNEL GRATES

SURFACE/VALVE BOXES

PUMP PARTS

END SUCTION PUMP PARTS

VERTICAL TURBINE PUMPS

AUTOMOBILE PARTS

PIPE FITTINGS AND VALVES

MINING AND CRUSHER PARTS

INVESTMENT CASTING





PROFILE

ABOUT US

As the first metal casting foundry in the State of Qatar, Suhail Factory for Metal Castings was built in the city of Mesaieed in 2022. It has two facilities that adopt the advanced technology in two different methods of metal casting. The first facility is a state-of-the-art sand-casting foundry using European technology, while the second facility is an investment-casting that is using the latest technology of robotic shelling process to achieve a perfect and consistent quality.

WHAT WE DO

1. The green sand-casting foundry at Suhail Factory for Metal Casting, metal is melted in either of three induction furnaces then molten metal is poured into sand molds that are formed using forming machines that mix sand materials, fill and press them onto patterns bearing the shape of the final product.
2. On the other hand, at the Investment Casting Facility, the patterns are shaped using wax injection machines, then the patterns are assembled and moved to the robotic shelling system where the shells are automatically prepared before moving them to dewaxing then shell firing and finally to metal pouring area.

Covering an area of 22,500 m², SFMC is capable to produce up to 40,000 Tons/ Annum of:

- Engineering Castings
- Automobile Cast Parts
- Oil and Gas Castings

VISION

To be a leading local manufacturer and dependable partner for our clients, offering engineered goods and solutions

MISSION

Supporting Qatar's social and economic development

- Improve local content by transferring technologies and developing human capital.
- Assist in the development of oil and gas, water, and other prospective industrial sectors.

Proactively involved with our major stakeholders

- Taking care of our people, our community, and the environment.
- Focus on operational excellence in engineered product manufacture.



FACILITIES

ENGINEERING CAPABILITIES

- Design, Research and Development.
- Reverse Engineering.
- 3D Scanning and 3D Modeling.
- Full Dimensional Analysis.
- Tooling and Patterns Designing (CNC Router, milling).
- Casting Solidification Simulation

MANUFACTURING CAPABILITIES

Sand casting Foundry

- Fully automatic DISA Flex molding line.
- Semi-Automatic DISA ARPA line.
- Induction Melting Furnace 3 tons x 3 nos.
- OMEGA core shooters.
- Fully automatic sand plant - DISA
- DISA shot blasting.
- Automatic coating line.

Investment casting

- Robotic Shelling System
- Semi-Automatic wax Injection Machines
- Dual track Induction Furnace

TESTING CAPABILITIES

- Advanced sand testing Laboratory.
- Metallurgical testing laboratory (Thermal Analysis, Spectrographic Analysis and Metallographic analysis with image Analyzer)
- Mechanical Testing Laboratory (UTM, Hardness testing and manhole cover Load Testing)
- NDT (RT, UT, MPI, LPT)

CERTIFICATIONS

- ISO 9001, ISO 14001, ISO 45001 and BSI Kitemark (EN 124-2)

MATERIAL SPECIFICATIONS

Sl.No	Material	International Standard	Reference products
1	Cast Iron	ASTM A48, ASTM A278, EN 1561, SAE J431	Automobile - Brake Drum, Disc Pump Parts - Intermediate Bowl, Impeller, Suction Bell, Suction Case, Discharge Case. Manhole covers and gully tops
2	Ductile Iron	ASTM A536, ASTM A 395, EN 1563, SAE J434	Automobile - Steering knuckle, Brake Calipers, Arm, Brake calipers and Carriers. Pump Parts - Intermediate Bowl, Impeller, Suction Bell, Suction Case, Discharge Case Engineering Parts - Valve Bodies, Bonnets, Yoke. Manhole covers and gully tops
3	Compacted Graphite Iron	ASTM A842, EN 16079	Turbo Housings, Break discs, Exhaust Manifold,
4	Steel	ASTM A351 & A 743 - Austenitic Stainless steel (CF3-304L, CF8-304, CF3M-316L, CF8M-316)	Pump Parts - Intermediate Bowl, Impeller, Suction Bell, Suction Case, Discharge Case Engineering Parts - Valve Bodies, Bonnets, Yoke.
		ASTM A352 - LCA, LCB, LCC, CA6NM	
		A 216 - WCA, WCB, WCC	
		A 217- WC6	Mining Industry, Jaw Crusher die, Steel Hammers, Crawler treads,
		A128 - Hadfield austenitic manganese steel castings	
		A 890/A 890M - Duplex Stainless Steel	Pump Parts - Intermediate Bowl, Impeller, Suction Bell, Suction Case, Discharge Case
5	Copper Alloys	ASTM B584 - Silicon Bronze, Manganese Bronze, High-lead tin bronze ASTM B148 - Aluminum Bronze, Nickel Aluminum Bronze	Pump Parts - Intermediate Bowl, Impeller, Suction Bell, Suction Case, Discharge Case Engineering Parts - Valve Bodies, Bonnets
6	Aluminium alloys	ASTM A356	Pump housings, impellers

MANHOLE COVERS



CIRCULAR COVERS AND FRAMES

SQUARE/RECTANGULAR COVERS AND FRAMES

GULLY GRATES AND FRAMES

CHANNEL GRATES

SURFACE/VALVE BOXES

MANHOLE COVERS

MANHOLE MATERIAL SELECTION

Suhail metal casting manufacture a range of high-performance cast-iron products including manhole covers/gully tops. We recognize the need to provide a material that is capable of combating the wear characteristics inherent with the increasing amount of vehicular traffic on our roads today.



Grey Cast Iron

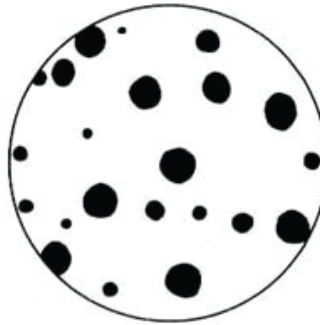







Ductile/Spheroidal Iron

THE DIFFERENCE BETWEEN DUCTILE AND GREY IRON

The addition of magnesium at the molten stage transforms the flakes of graphite, which are common with the grey iron casting process, into spheroidal or nodular form. The spheroidal structure provides a higher tensile strength as well as a higher 'Strength to weight' ratio when compared with the properties inherent with grey.

MANHOLE COVERS

PRODUCT CLASS(LOAD)

CLASS	LOAD BEARING REQUIRED	APPLICATION IN APPROPRIATES AREAS
A 15	15 KN (3400 lbf)	FOR USE IN PEDESTRIAN AREA 
B 125	125 KN (28200 lbf)	FOR USE IN FOOTWAYS, PEDSTRIAN AREAS AND CAR PARKS 
C 250	250 KN (56300 lbf)	FOR USE IN KERBSIDE CHANNELS OF ROADS AND CAR PARKS. 
D 400	400 KN (90000 lbf)	FOR USE IN CARRIAGEWAYS, HARD SHOULDERS AND PARKING AREAS. 
E 600	600 KN (134900 lbf)	FOR USE IN HIGH WHEEL LOADS AREAS LIKE DOCKS AND AIRCRAFT PAVEMENT. 
F 900	900 KN (202400 lbf)	FOR USE IN VERY HIGH WHEEL LOADS AREAS AIRCRAFT PAVEMENTS. 

MANHOLE COVERS

CIRCULAR COVERS AND FRAMES

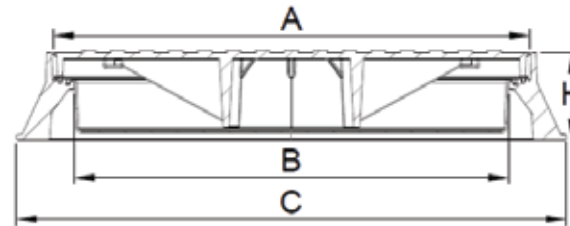
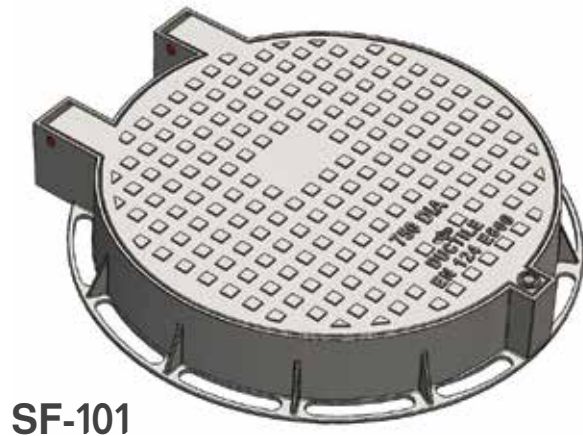

FEATURES

Features

- Hinged cover
- Cover locked with frame (SS Bolt)
- Cushion insert (Rubber gasket)

Options

- GRP seal plate provision
- Grease seal

Product No.	B Ø (mm)	A Ø (mm)	C Ø(mm)	H (mm)	Load Class	Material
SF-101	750	823	950	150	EN 124: E600	DUCTILE IRON

FEATURES

Features

- Hinged cover
- Cover locked with frame (SS Bolt)
- Cushion insert (Rubber gasket)

Options

- GRP seal plate provision
- Grease seal

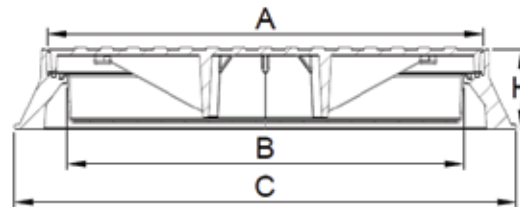

SF-102

Product No.	B Ø (mm)	A Ø (mm)	C Ø(mm)	H (mm)	Load Class	Material
SF-102	750	823	950	100	EN 124: D400	DUCTILE IRON

MANHOLE COVERS

CIRCULAR COVERS AND FRAMES

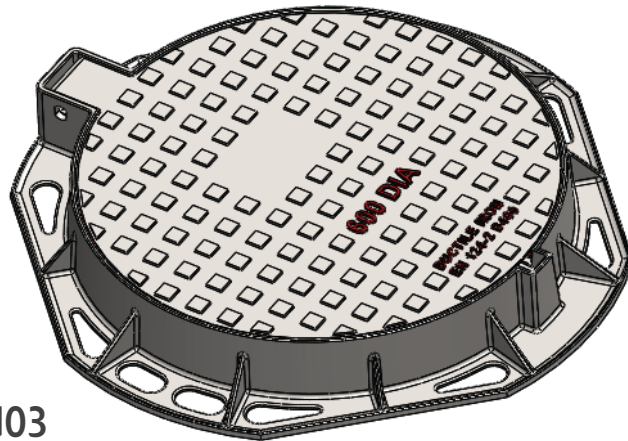

SF-103

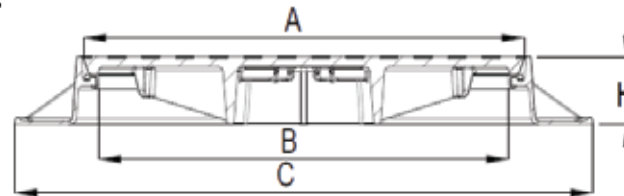

FEATURES

Features

- Hinged cover.
- Cover Self locked with frame
- Cushion insert (Rubber gasket)

Options

- Additional lock.
- Anti-theft Hook

Product No.	B Ø (mm)	A Ø (mm)	C Ø(mm)	H (mm)	Load Class	Material
SF-103	600	650	850	100	EN 124:D400	DUCTILE IRON

FEATURES

Features

- Cover Self locked with frame
- Seal

Options

- Additional lock

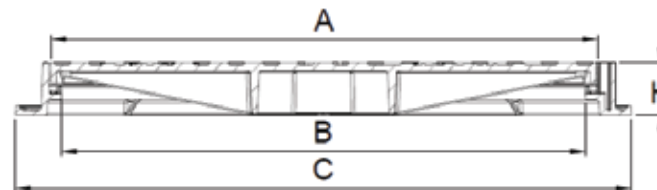

SF-104

Product No.	B Ø (mm)	A Ø (mm)	C Ø(mm)	H (mm)	Load Class	Material
SF-104	600	617	710	60	EN 124:B125	DUCTILE IRON

MANHOLE COVERS

SQUARE/RECTANGULAR COVERS AND FRAMES

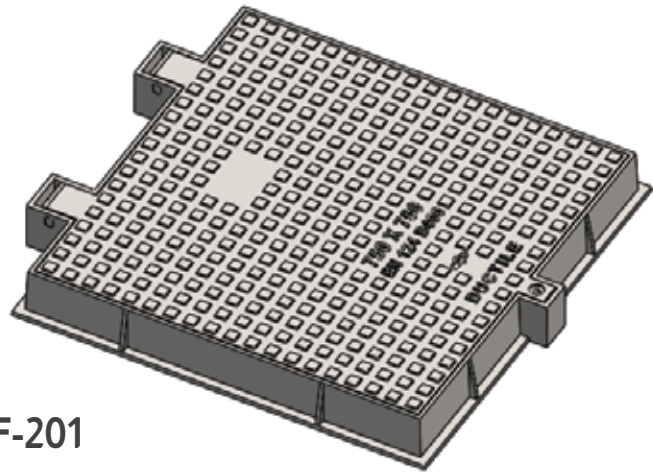

SF-201

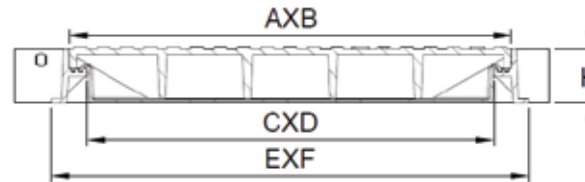

FEATURES

Features

- Hinged cover
- Cover locked with frame (SS Bolt)
- Cushion insert (Rubber gasket)

Options

- GRP seal plate provision

Product No.	CXD (mm)	AXB (mm)	EXF (mm)	H (mm)	Load Class	Material
SF-101	750X750	815x815	950X950	100	EN 124: D400	DUCTILE IRON

FEATURES

Features

- Hinged covers.
- Double triangular covers
- Cover locked with frame

Options

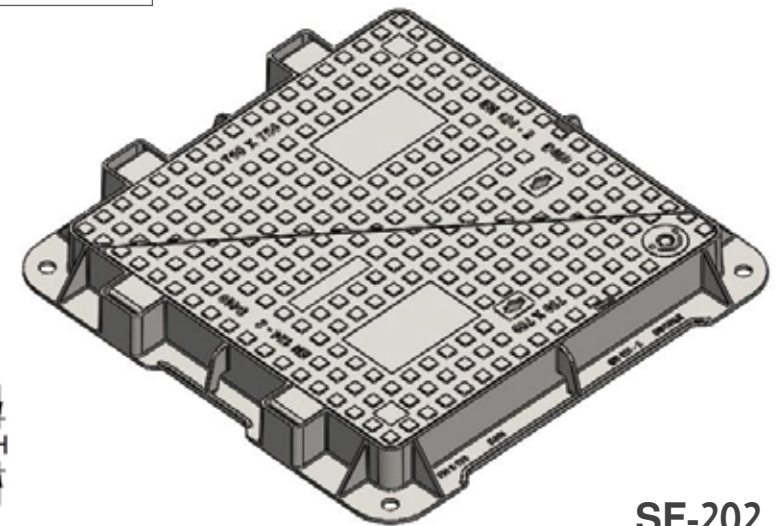
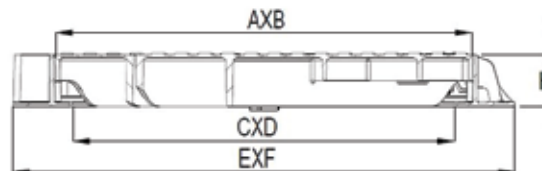

SF-202

Product No.	CXD (mm)	AXB (mm)	EXF (mm)	H (mm)	Load Class	Material
SF-202	750X750	805X805	970X970	100	EN 124: D400	DUCTILE IRON

MANHOLE COVERS

SQUARE/RECTANGULAR COVERS AND FRAMES

FEATURES

Features

- Double Triangular covers
- Covers connected with SS bolts
- Cover locked with frame

Options

- GRP seal plate provision

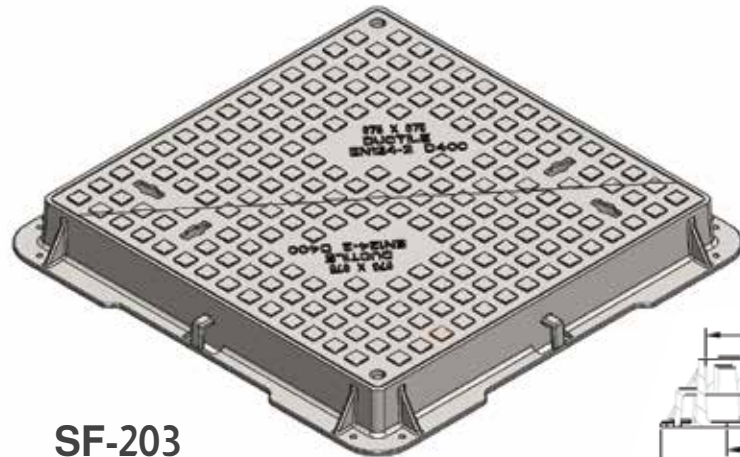

SF-203



Product No.	CXD (mm)	AXB (mm)	EXF (mm)	H (mm)	Load Class	Material
SF-101	675x675	730x730	855x855	100	EN 124: D400	DUCTILE IRON

FEATURES

Features

- Double Triangular covers
- Covers connected with SS bolts

Options

- Cover locked with frame



SF-204



Product No.	CXD (mm)	AXB (mm)	EXF (mm)	H (mm)	Load Class	Material
SF-204	900x600	895x895	1050x750	100	EN 124: D400	DUCTILE IRON

MANHOLE COVERS

SQUARE/RECTANGULAR COVERS AND FRAMES

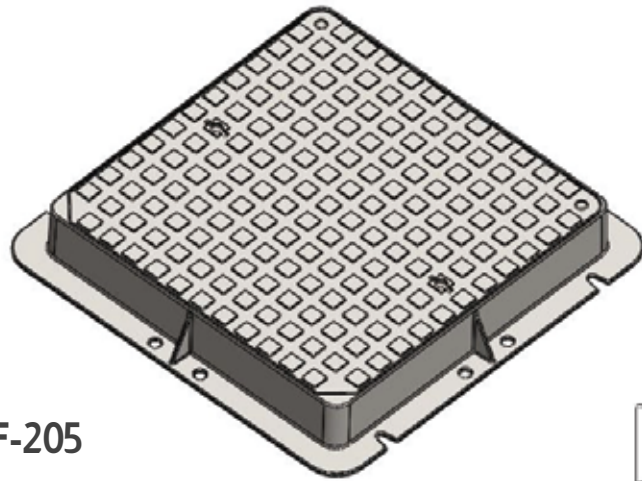

SF-205

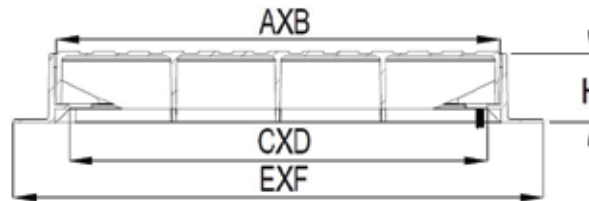

FEATURES

Features

- Cover locked with frame
- Slide out cover

Options

- Cushion insert

Product No.	CXD (mm)	AXB (mm)	EXF (mm)	H (mm)	Load Class	Material
SF-205	600X600	635X635	760X760	100	EN 124: D00	DUCTILE IRON

GULLY GRATES AND FRAMES

FEATURES

Features

- Hinged Grate

Options

- Lockable

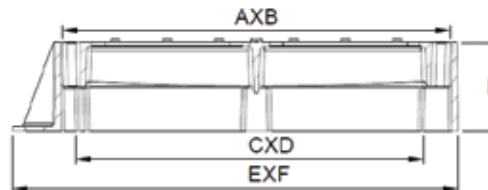

SF-401

Product No.	CXD (mm)	AXB (mm)	EXF (mm)	H (mm)	Load Class	Material
SF-401	400X400	435X435	500X550	100	EN 124: D00	DUCTILE IRON

MANHOLE COVERS

GULLY GRATES AND FRAMES



SF-402

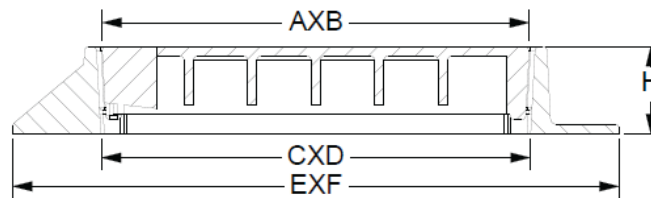

FEATURES

Features

- Hinged Grate

Options

- Lockable

Product No.	CXD (mm)	AXB (mm)	EXF (mm)	H (mm)	Load Class	Material
SF-402	380X400	370X390	525X495	75	EN 124: C250	DUCTILE IRON

FEATURES

Options

- Hinged Grate
- Grate locked with frame

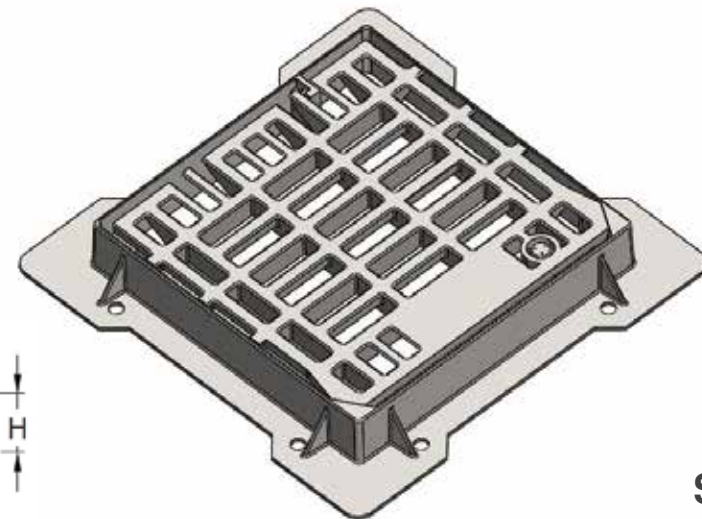

SF-403

Product No.	CXD (mm)	AXB (mm)	EXF (mm)	H (mm)	Load Class	Material
SF-403	600x600	580x580	1800x800	100	EN 124: D00	DUCTILE IRON

MANHOLE COVERS

CHANNEL GRATES

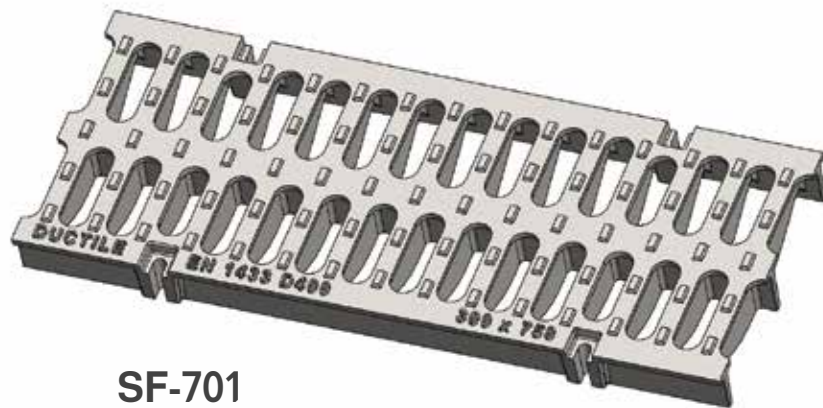

SF-701

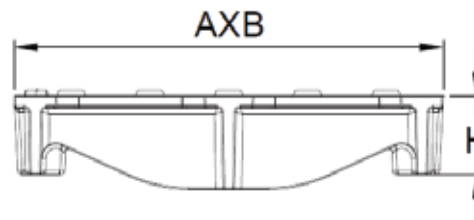

FEATURES

Features

- Lockable Channel grate

Options

- With side Frames

Product No.	AXB (mm)	H (mm)	Load Class	Material
SF-701	300X750	55	EN 1433: D400	DUCTILE IRON

FEATURES

Features

- Lockable channel grate.
- Side frames

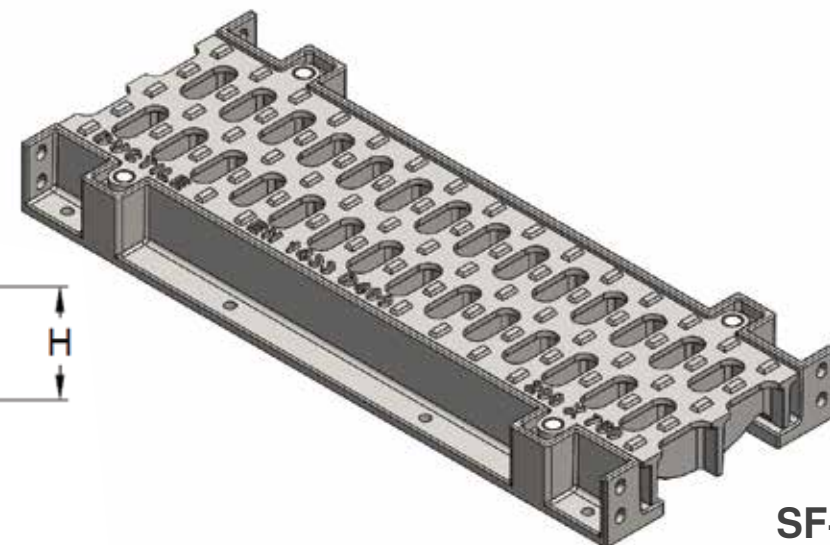
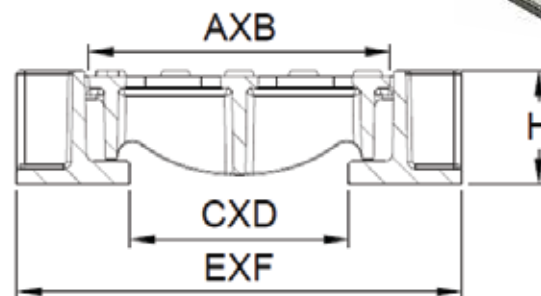

SF-702

Product No.	CXD (mm)	AXB (mm)	EXF (mm)	H (mm)	Load Class	Material
SF-702	145X750	200X750	295X750	75	EN 1433: D400	DUCTILE IRON

MANHOLE COVERS

SURFACE/VALVE BOXES

FEATURES

Features

- Double Triangular cover
- Covers connected with SS bolt

Options

- Cover secured with chain

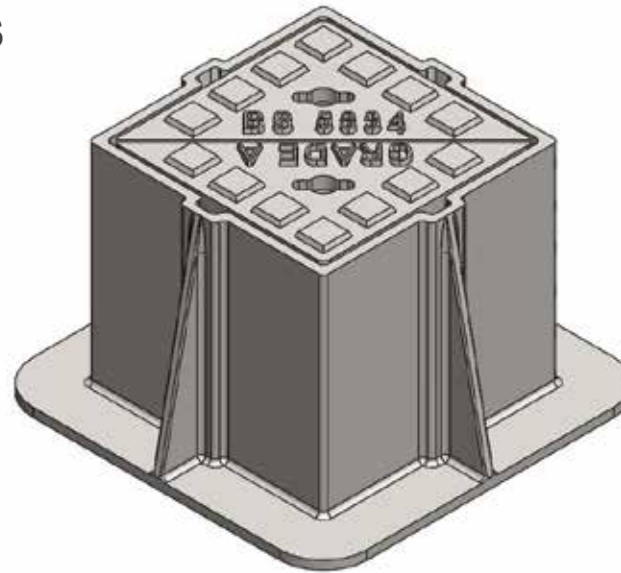
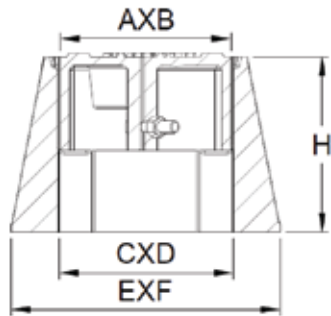

SF-501

Product No.	CXD (mm)	AXB (mm)	EXF (mm)	H (mm)	Load Class	Material
SF-501	150x150	145x145	230x230	150	BS 5834 GRADE A	DUCTILE IRON

FEATURES

Options

- Cover secured with chain.
- Adjustable cover.

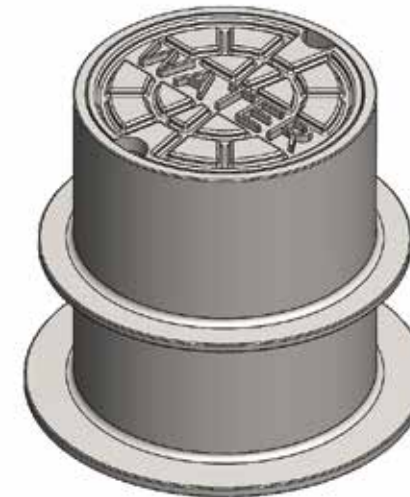
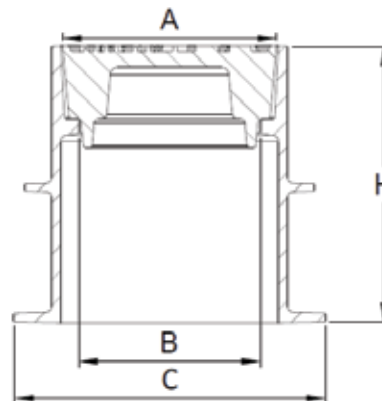

SF-502

Product No.	B Ø (mm)	A Ø (mm)	C Ø (mm)	H (mm)	Load Class	Material
SF-502	160	185	270	240	BS 5834 GRADE A	GREY CAST IRON

MANHOLE COVERS

SURFACE/VALVE BOXES

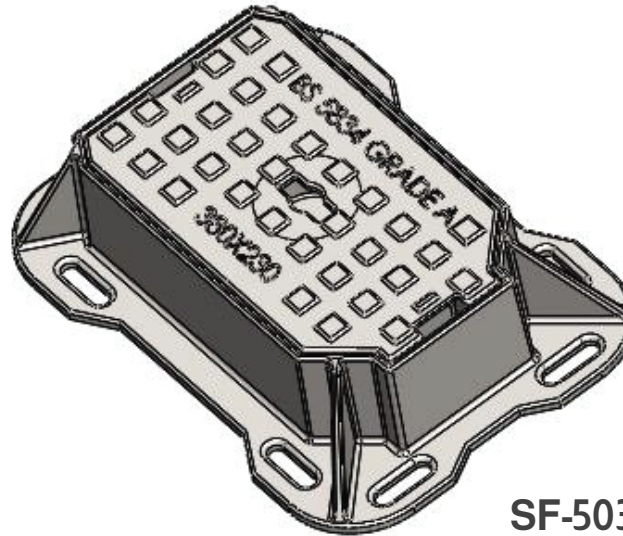
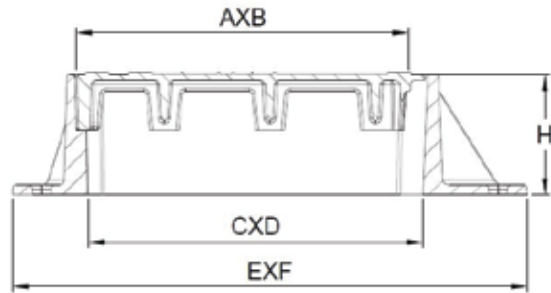

SF-503

FEATURES

Features

- Covers connected with SS Chain.
- Wedge seating

Product No.	CXD (mm)	AXB (mm)	EXF (mm)	H (mm)	Load Class	Material
SF-503	380X230	405X235	535X385	125	BS 5834 GRADE A	DUCTILE IRON

PUMP PARTS

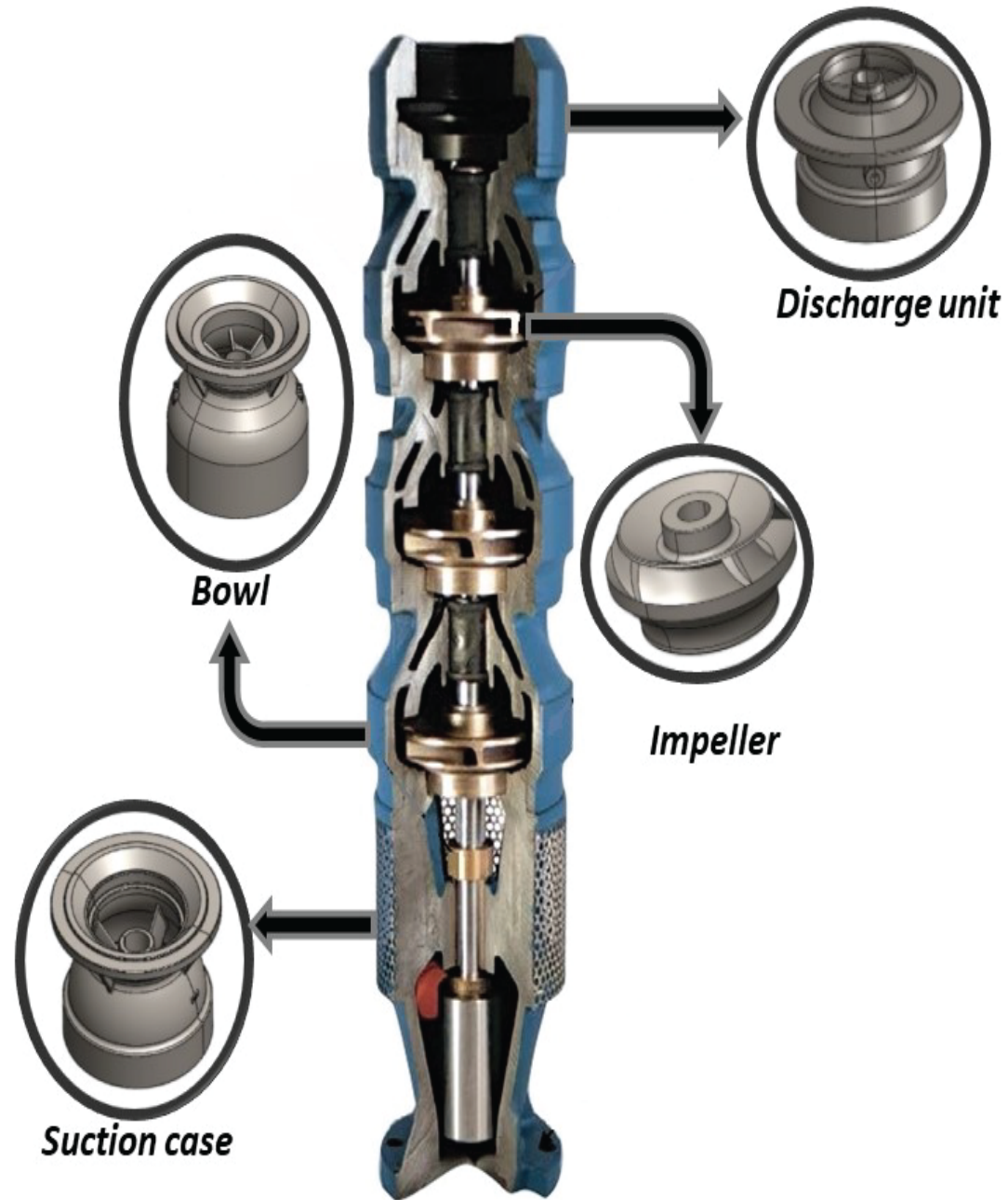

VERTICAL TURBINE PUMP PARTS

INTERMEDIATE BOWL

PUMP BOWLS shall be of close grained , produced with different materials as per application requirement. It should be free from blow holes, sand defects, or other detrimental faults and shall be accurately machined and fitted to close tolerances. The bowls shall have vitreous enamel lined waterways to reduce friction losses and provide a maximum efficiency and wear protection.

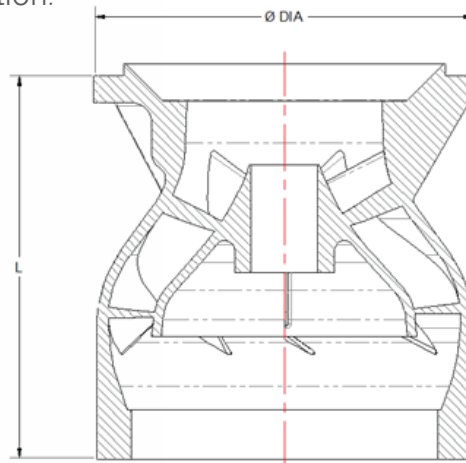
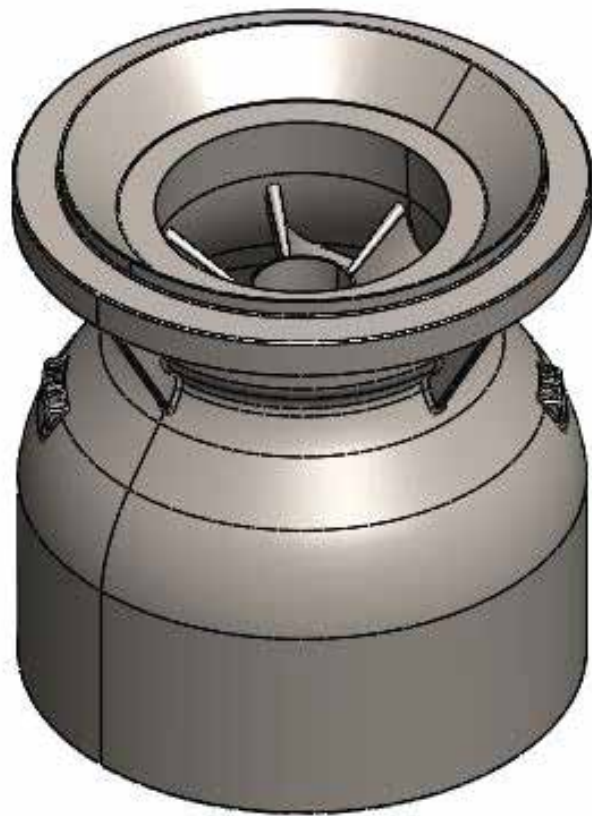

BOWL SIZES	Ø DIA (inch)	L (inch)	MATERIAL
5"	5.20	4.625	Cast iron - ASTM A48, ASTM A278 Ductile iron-ASTM A536, ASTM A395 Steel-ASTM A216, ASTM A351/A743 Bronze-ASTM B584, ASTM B148
6"	5.5	4	
7"	7	6.75	
8"	8.13	7.25	
9"	9	8	
10"	10.13	9.63	
12"	11.5	10.5	
14"	14.13	13.25	
16"	15.63	14.69	

VERTICAL TURBINE PUMP PARTS

DISCHARGE CASE

DISCHARGE CASE shall be cast with by-pass ports to allow release of fluids through the throttle bearing. The discharge case shall be fitted with a Bowl Adapter Tube for connection to the enclosing tube and threaded for connection to the discharge column pipe. The Bowl Adapter Tube will have a bronze sleeve bearing in the bottom and threaded for a bronze line shaft bearing on top.

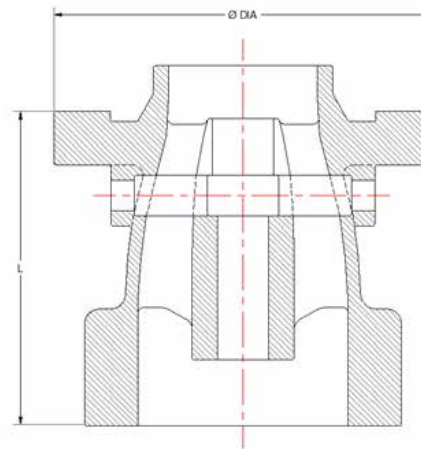
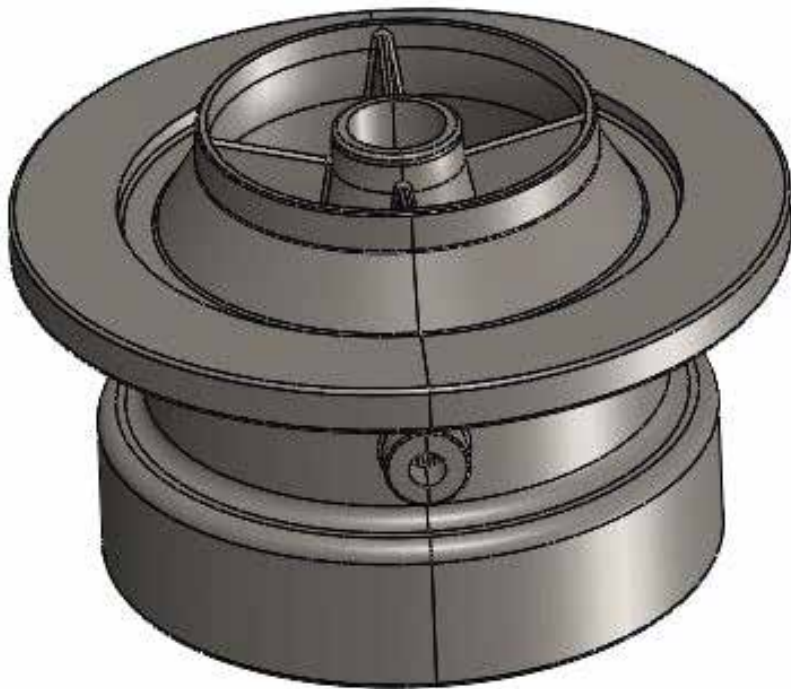

DIS.CASE SIZES	\varnothing DIA(inch)	L(inch)	MATERIAL
5"	5.20	4.75	Cast iron - ASTM A48, ASTM A278 Ductile iron-ASTM A536 ASTM A395 Steel-ASTM A216, ASTM A351/A743 Bronze-ASTM B584, ASTM B148
6"	5.5	5.25	
7"	7	6.75	
8"	8.13	8.85	
9"	9	8.85	
10"	10.13	7.5	
12"	11.5	10.9	
14"	14.13	10	
16"	15.63	9.7	

VERTICAL TURBINE PUMP PARTS

IMPELLER

IMPELLERS shall be , produced with different materials as per application requirement and shall be enclosed type accurately machined, balanced, and filed for optimum performance. They shall be securely fastened to the shaft with a taper split collet of C1215 steel or SS316 stainless steel.

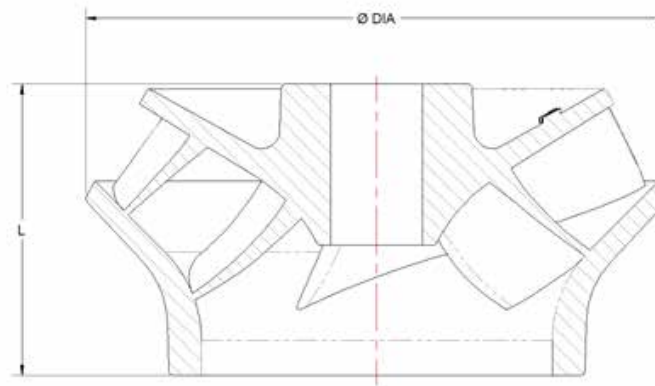
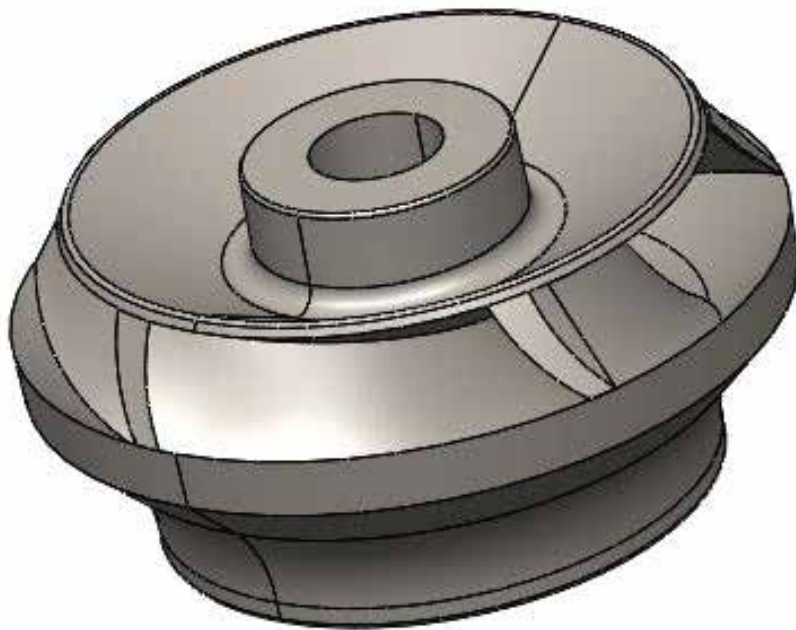

IMPELLER SIZES	Ø DIA(inch)	L(inch)	MATERIAL
5"	4	2.5	Cast iron - ASTM A48, ASTM A278 Ductile iron-ASTM A536, ASTM A395 Steel-ASTM A216, ASTM A351/A743 Bronze-ASTM B584, ASTM B148
6"	4.84	2.75	
7"	5.68	3.25	
8"	6.88	4.4	
9"	6.85	3.74	
10"	8.25	4.13	
12"	8.75	4.68	
14"	11	6.1	
16"	12.98	6.5	

VERTICAL TURBINE PUMP PARTS

SUCTION CASE

SUCTION CASE shall be fitted with a replaceable wear ring of bismuth bronze C89835, grease packed bismuth bronze C89835 bearing and protected by a bismuth bronze C89835 sand collar.

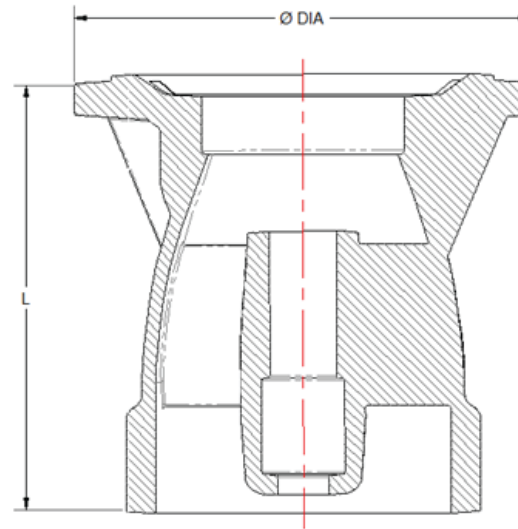
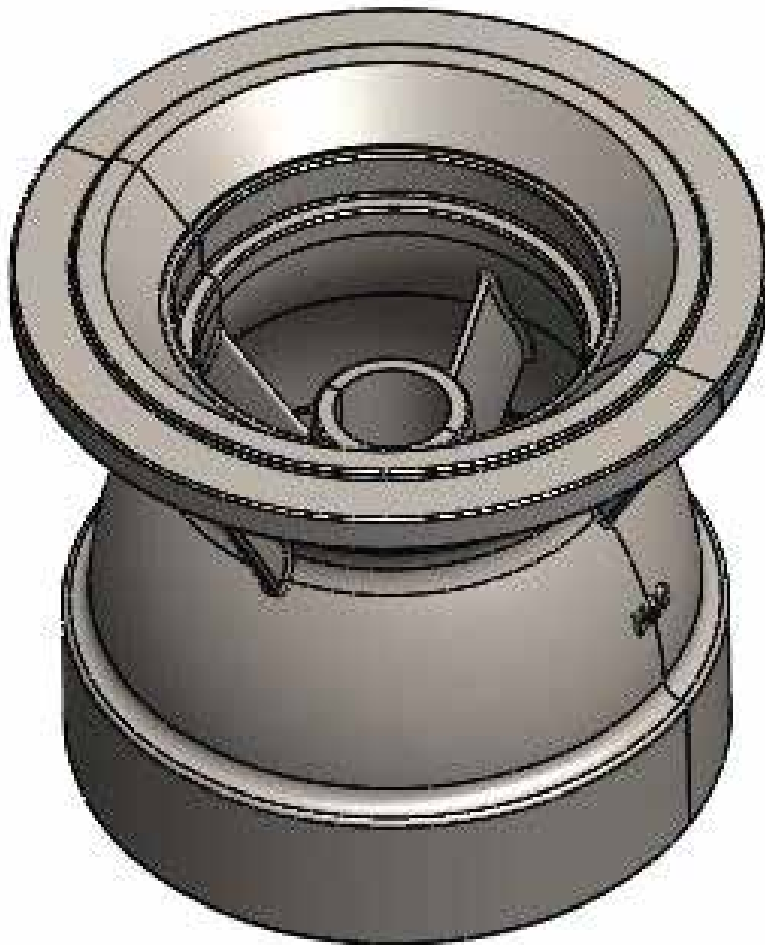

SUC.CASE SIZES	Ø DIA(inch)	L(inch)	MATERIAL
5"	5.20	6.5	Cast iron - ASTM A48, ASTM A278 Ductile iron-ASTM A536, ASTM A395
6"	5.5	7.06	
7"	7	8.25	
8"	8.13	8.38	
9"	9	8.38	
10"	10.13	10.69	
12"	11.5	10.88	
14"	14.13	12.25	
16"	15.63	13	

VERTICAL TURBINE PUMP PARTS

PIPE COUPLING

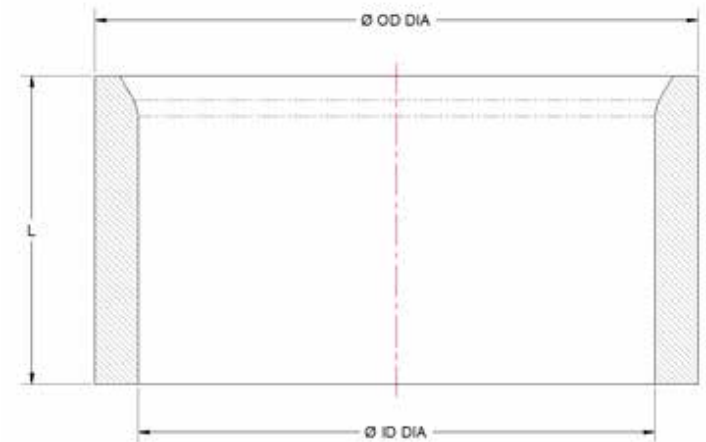

COUPLING SIZE	Ø OD DIA(inch)	Ø ID DIA(inch)	L(inch)	MATERIAL
3"	3.875	3	3.5	Ductile Iron - ASTM A536, EN 1563 Bronze - ASTM B584, ASTM B148
4"	5.063	4	3.94	
5"	6.325	5.25	4.375	
6"	7.412	6.2	4.375	
8"	9.562	8.2	4.875	
10"	11.787	10.25	6.373	
12"	14.063	12.37	6.25	

END SUCTION PUMP PARTS

PUMP CASE

The casing is back pull-out design to allow pulling out the internal components (rotating parts) for inspection and /or replacement without disturbing the pipe work. The volute made of fine grain cast iron equipped with Integrated support feet.

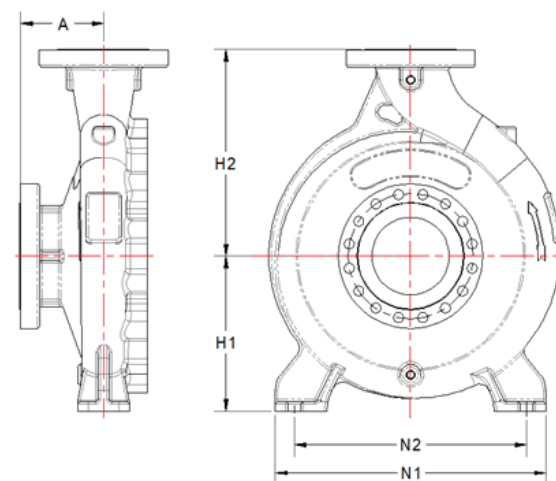
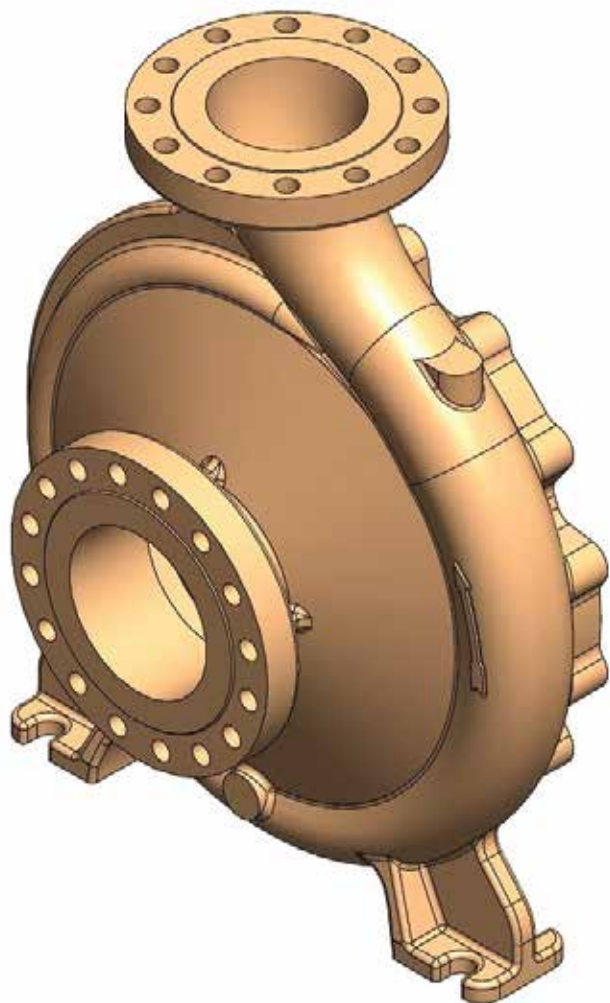

PUMP CASING SIZES (MM)	DNa	DNm	A	H1	H2	N1	N2
40-200	65	40	100	160	180	265	212
40-250	65	40	100	180	225	320	250
65-250	80	65	100	200	250	360	280
65-315	80	65	125	225	280	400	315
80-250	100	80	125	200	280	400	315
MATERIAL							
Gray Iron - ASTM A48,A278							
Ductile Iron - ASTM A395,A536							
Bronze - ASTM B584							
Maximum Size			Up to 700x700x 350 mm				
Maximum Weight			Up to 150 kg				

END SUCTION PUMP PARTS

SPLIT CASE PUMP CASING TOP AND BOTTOM

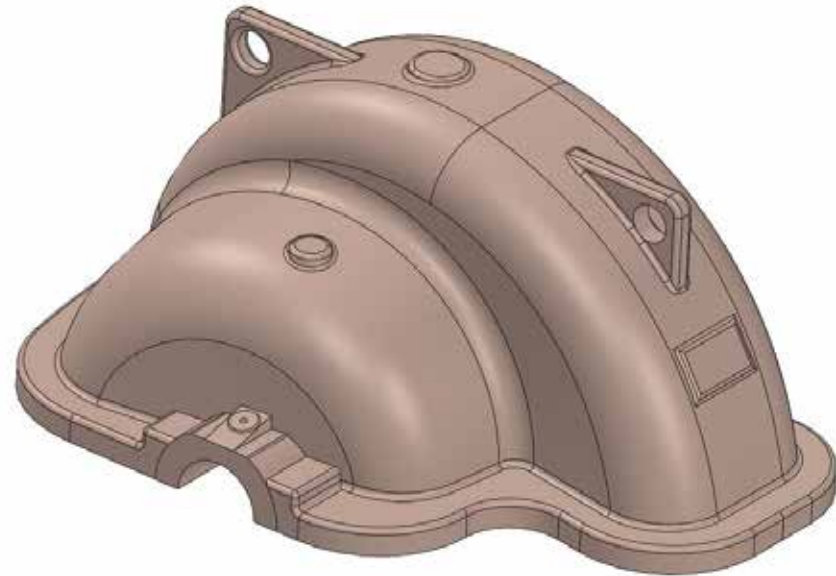
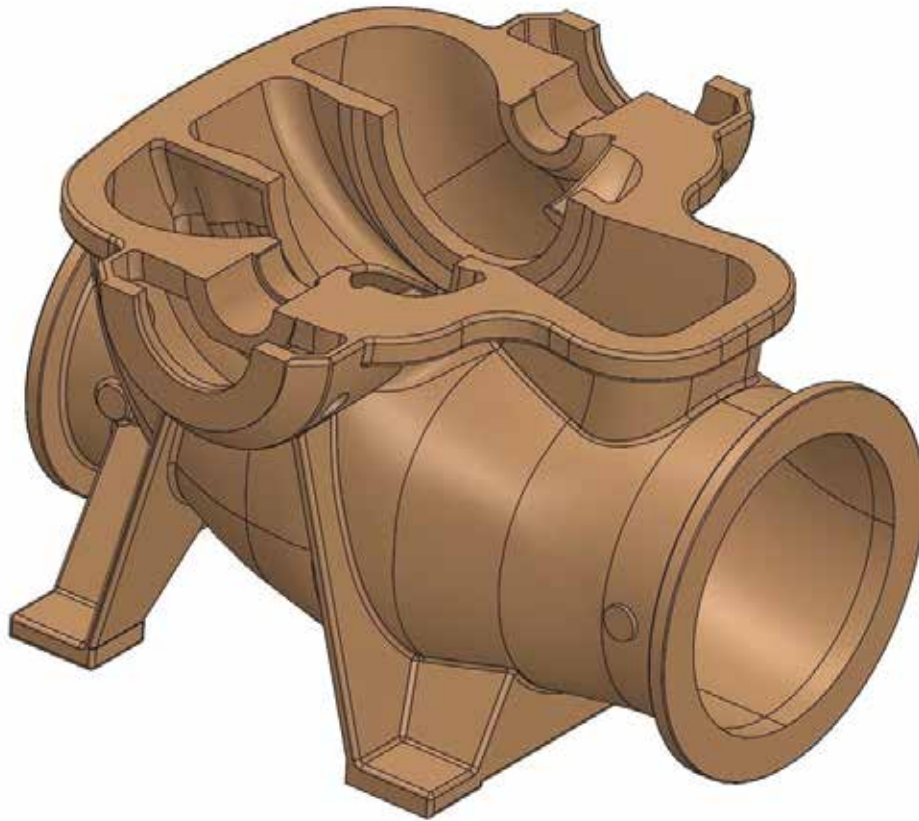

MATERIAL

Gray Iron - ASTM A48,A278
Ductile Iron - ASTM A395,A536
Bronze - ASTM B584

Maximum Size	Up to 700x700x 350 mm
Maximum Weight	Up to 150 kg

GENERAL PUMP PARTS

STATOR HOUSINGS, END SHIELDS, FLANGE BEARING SHIELDS & TERMINAL BOXES



MATERIAL	
Gray Iron - ASTM A48	
Maximum Size	Up to 700x700x 350 mm
Maximum Weight	Up to 150 kg



AUTOMOBILE PARTS

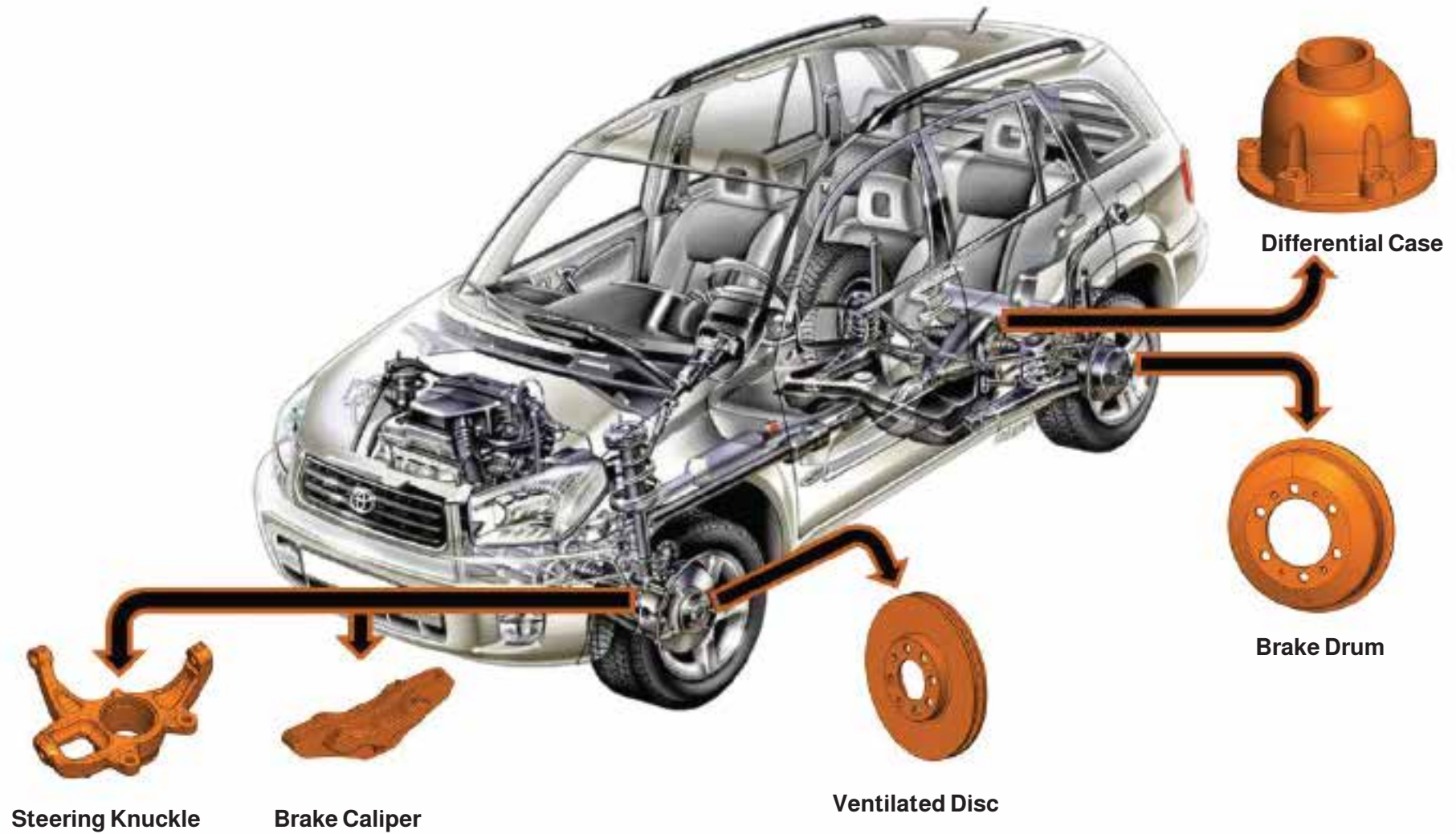

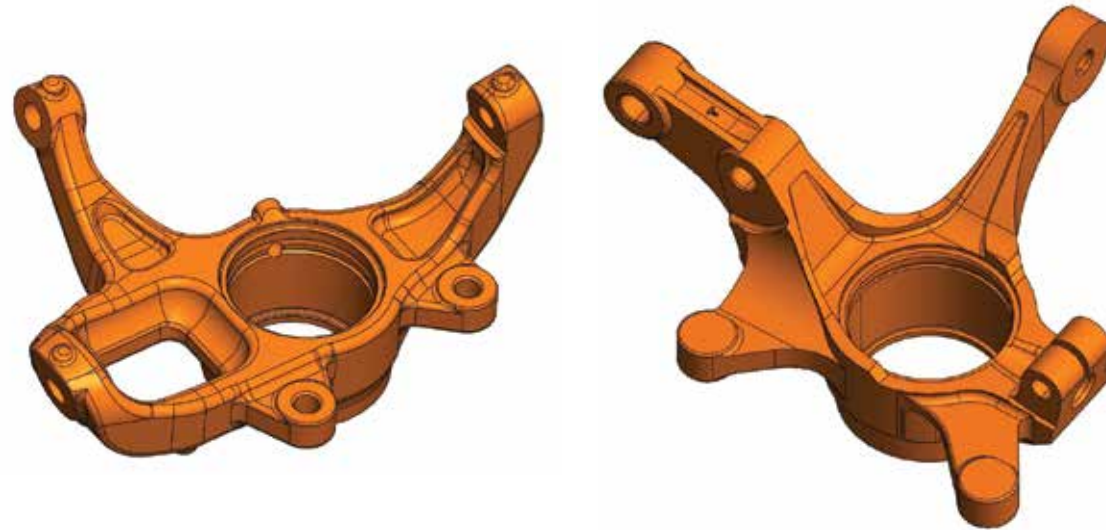

STEERING KNUCKLES

MATERIAL	
Ductile Iron - (ASTM A536,EN 1563,SAE J434) with different grades	
Maximum Size	Up to 350 x 350 mm
Maximum Weight	Up to 25 kg

BRAKE CALIPER AND CARRIER

MATERIAL	
Ductile Iron - (ASTM A536,EN 1563,SAE J434) with different grades	
Maximum Size	350 mm Length
Maximum Weight	Up to 50 kg

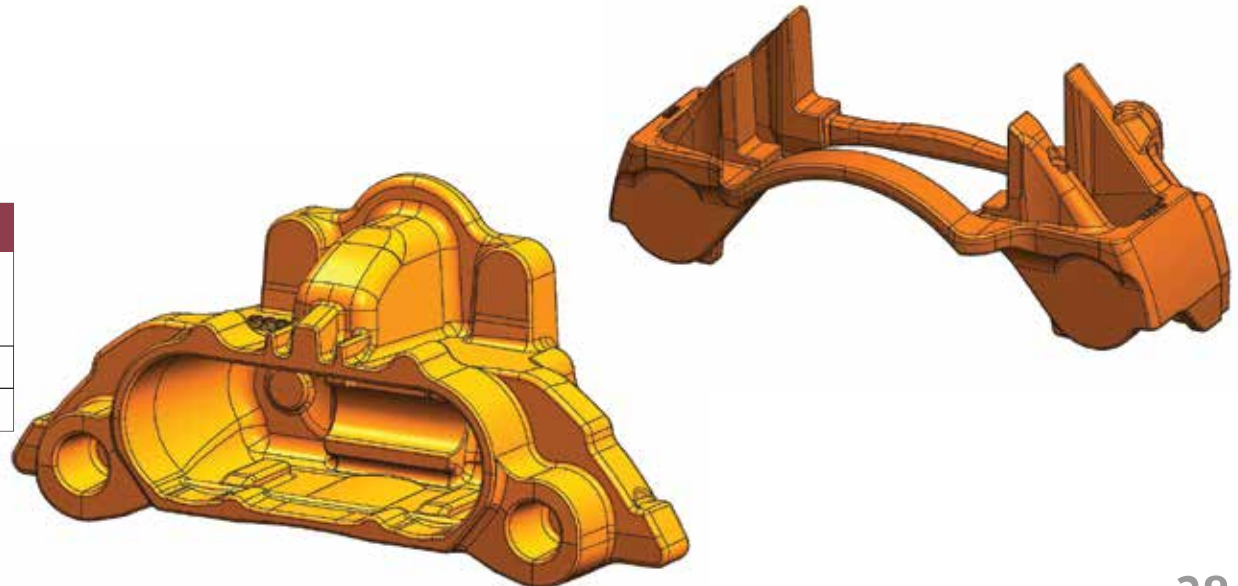

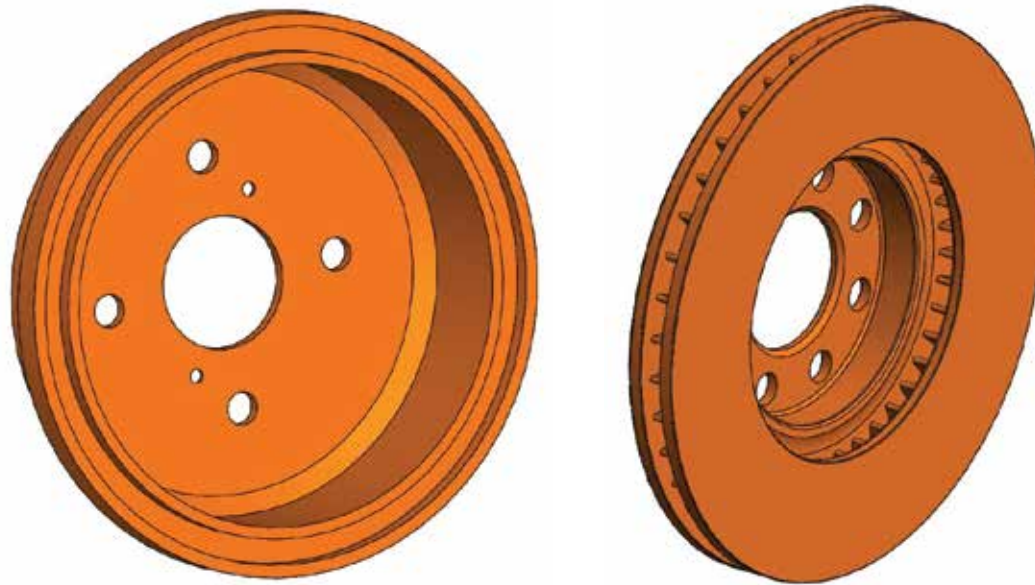

BRAKE DRUM AND BRAKE DISC

MATERIAL	
Grey Iron - ASTM A48, EN 1561, SAE J431 with different grades	
Maximum Size	Outside Diameter of 600 mm
Maximum Weight	Up to 100 kg

CLUTCH-PRESSURE PLATES AND FLYWHEELS

MATERIAL	
Grey Iron - ASTM A48, EN 1561, SAE J431 with different grades	
Maximum Size	Outside Diameter of 600 mm
Maximum Weight	Up to 150 kg

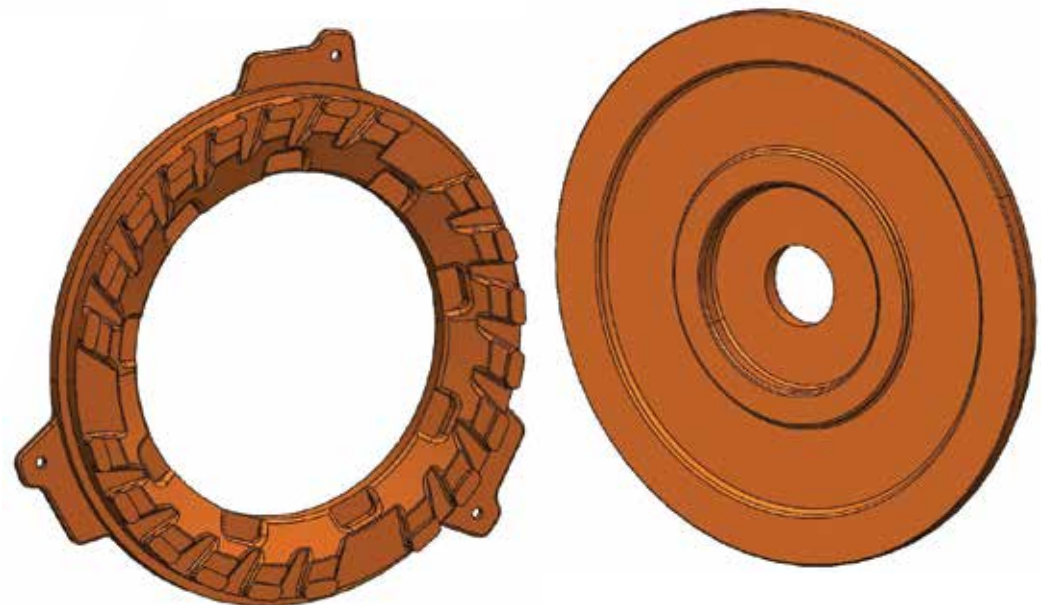

BRACKETS

MATERIAL	
Ductile Iron - ASTM A536, EN 1563, SAE J434 with different grades	
Maximum Size	Up to a length of 700 mm
Maximum Weight	Up to 100 kg

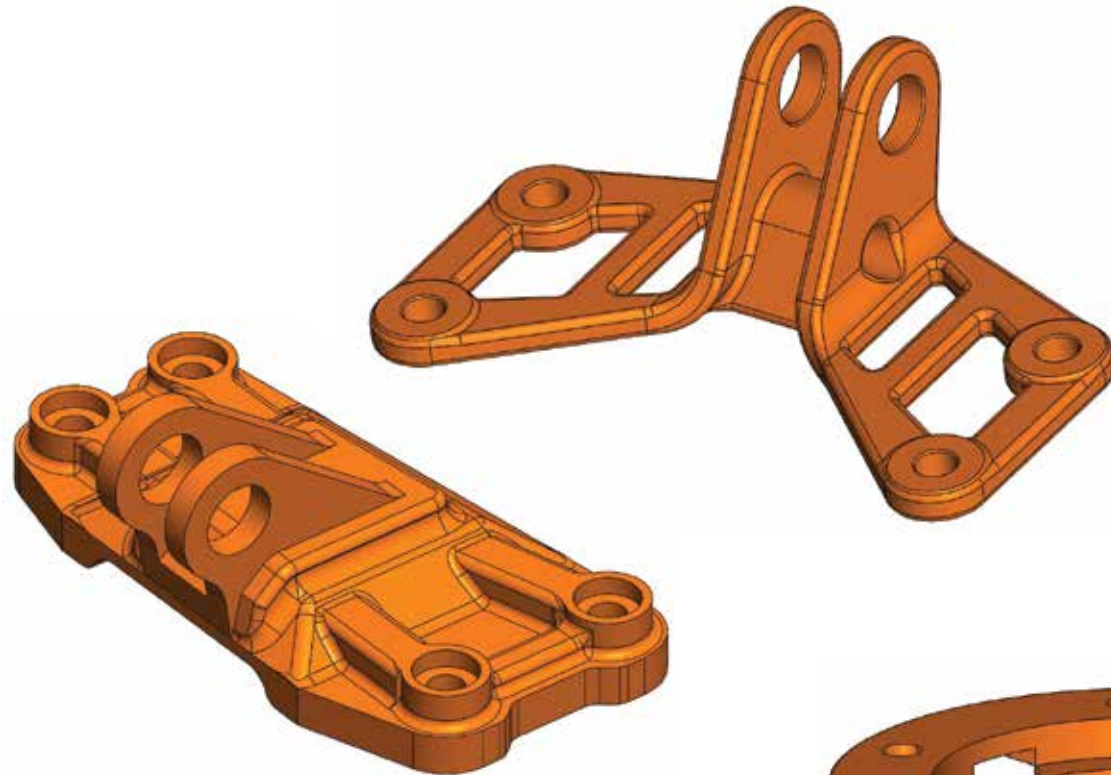

DIFFERENTIAL CASE AND UPPER ARM

MATERIAL	
Ductile Iron - ASTM A536, EN 1563, SAE J434 with different grades	
Maximum Size	Up to a length of 350 mm
Maximum Weight	Up to 50 kg

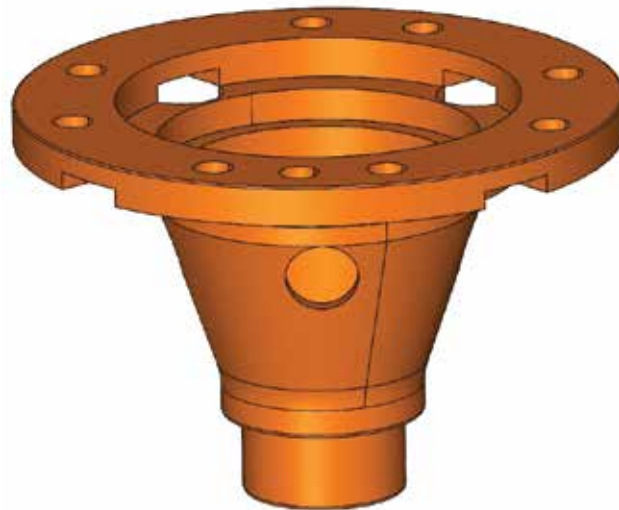

PIPE FITTINGS AND VALVES

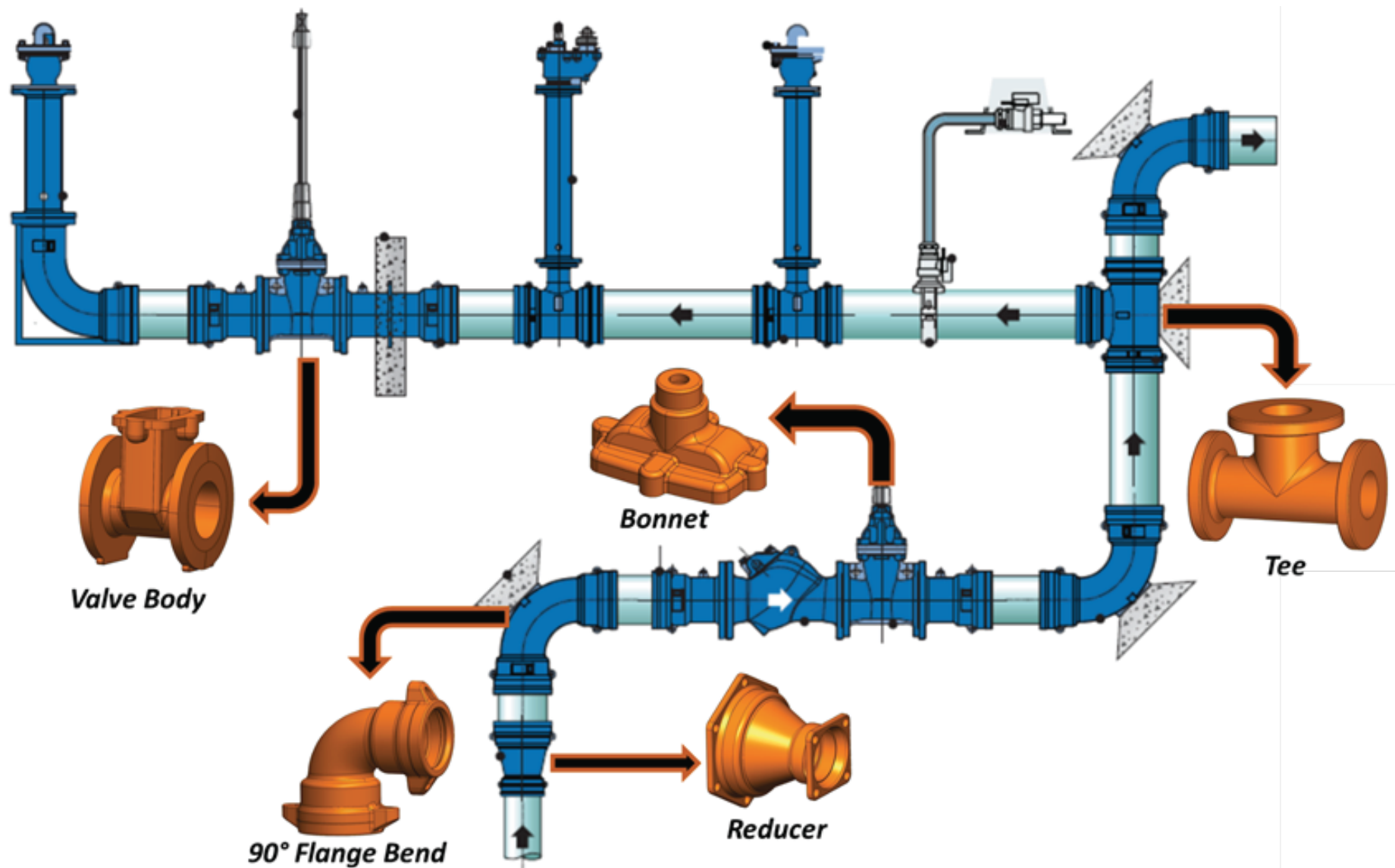

PIPE FITTINGS AND VALVES

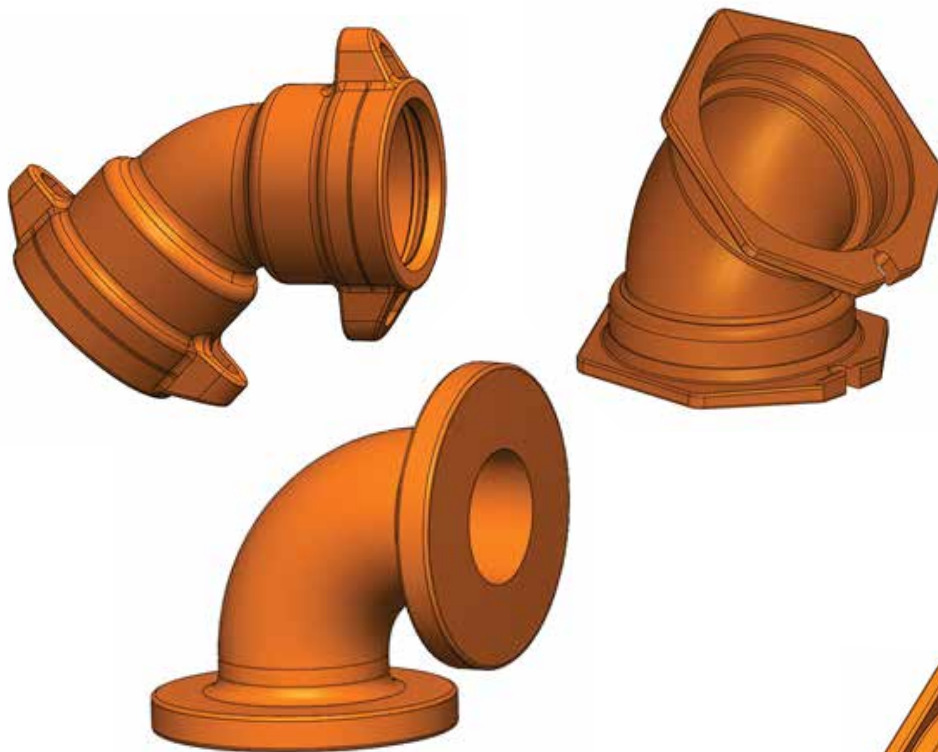

BEND

Above bends are used to transfer high pressurized water.

MATERIAL	
Ductile Iron - ASTM A536, A395	
Pressure Rating	350 PSI OR As per required

TYPES	DESCRIPTION	SIZE (INCH)
PUSH ON BEND	45 DEGREE	4, 6, 8
PUSH ON BEND	90 DEGREE	4, 6, 8
FLANGE BEND	45 DEGREE	4, 6, 8, 10
FLANGE BEND	90 DEGREE	4, 6, 8, 10
MJ BEND	45 DEGREE	4, 6, 8, 10
MJ BEND	90 DEGREE	4, 6, 8, 10

TEE AND CROSS

MATERIAL	
Ductile Iron - ASTM A536, A395	
Pressure Rating	350 PSI OR As per required

TYPES	DESCRIPTION	SIZE (INCH)
Tee	Flange Tee	2 x 2, 4 x 4, 6 x 6, 8 x 8, 10 x 10
CROSS	MJ CROSS	2 x 2, 4 x 4, 6 x 6, 8 x 8, 10 x 10
REDUCER	CONCETRIC	4 X3, 6 X3, 6 X4

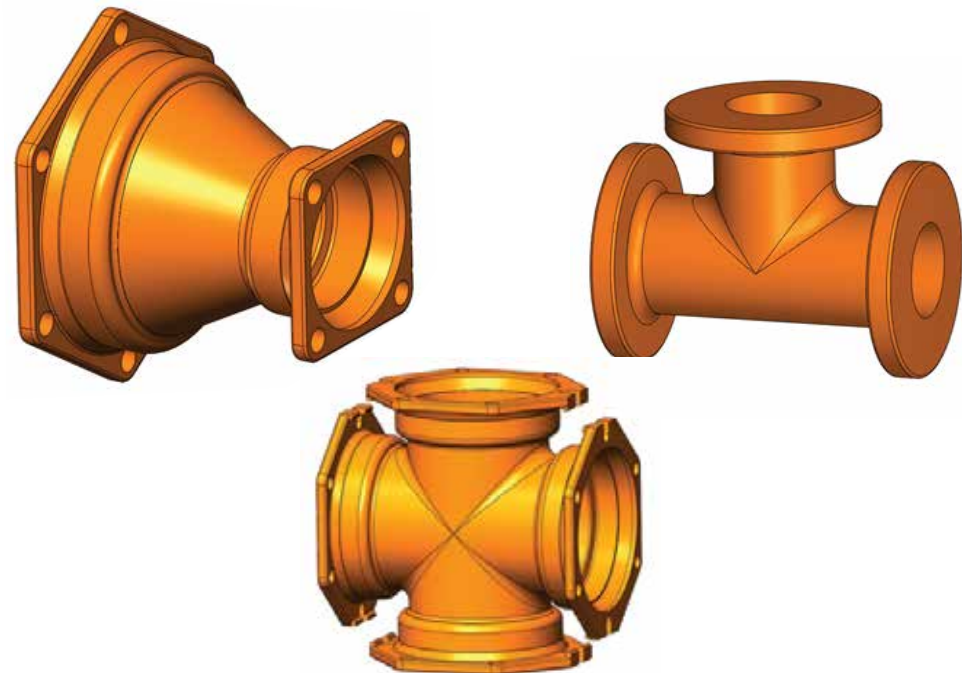

Above Tee and Cross are used to divert the high pressurized water.

PIPE FITTINGS AND VALVES

VALVES

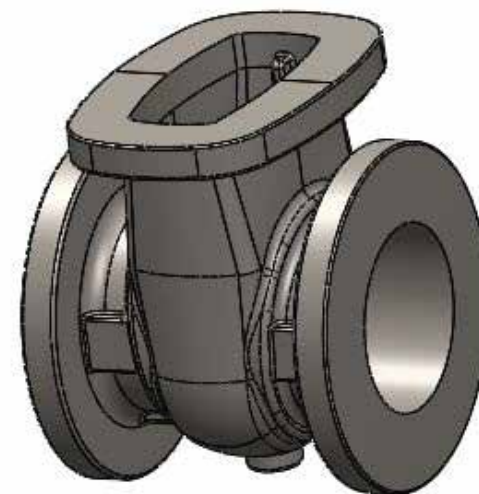
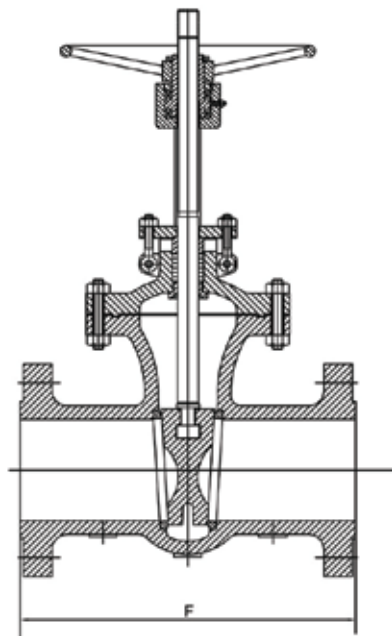
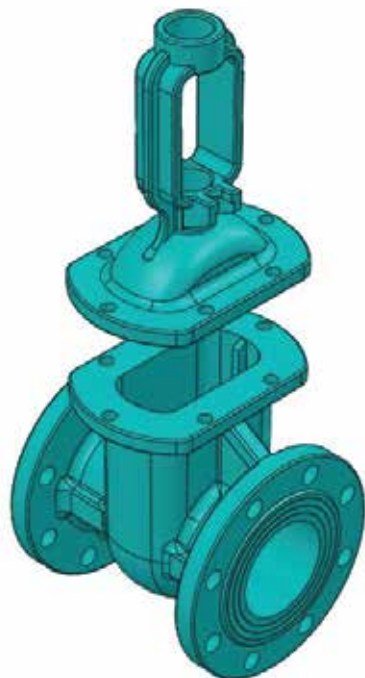

OD Diameter mm	50	65	80	100	125	150	200	250	300
F, mm	292	330	356	432	508	559	660	787	838
H Approx.	370	450	480	530	635	635	870	1130	1320

MATERIAL			PRESSURE RATINGS
Body, Bonnet	Body (Seat), Ring	Hand Wheel	
ASTM A395, EN 1563	ASTM A395, EN 1563	ASTM A536, EN 1563	
			350 PSI OR as per Customer requirements

MINING AND CRUSHER PARTS



MINING AND CRUSHER PARTS

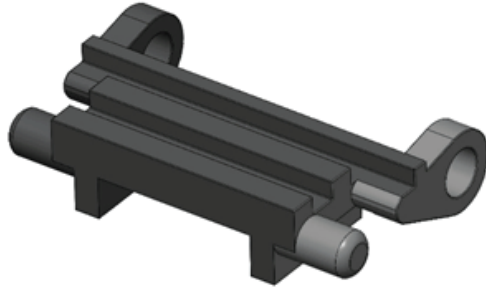

TRACK SHOE



TEETH

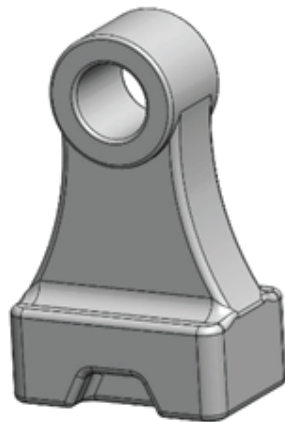

STEEL SHREDDER HAMMER

MINING INDUSTRY PARTS

Parts are used for High wear resistance required areas

Material

Steel – Hadfield Manganese Steel – ASTM A 128

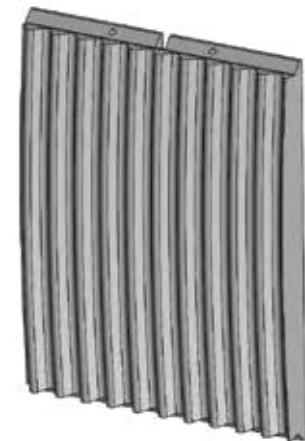

CRUSHER DIE

INVESTMENT CASTING



INVESTMENT CASTING PARTS

Open Type Impeller

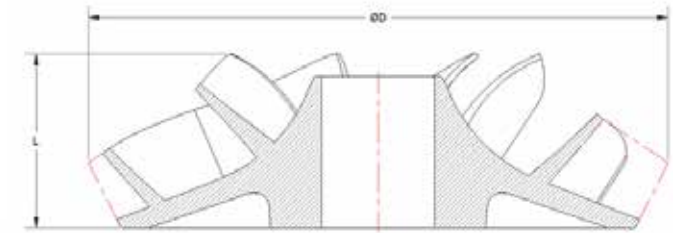

IMPELLER SIZE	Ø DIA	L
5"	4	1.25
6"	4.84	1.5
7"	5.68	1.75
8"	6.88	2
9"	6.85	2.25
10"	8.25	2.5
12"	8.75	3
14"	11	3.25
16"	12.98	3.5

Other type of Impellers

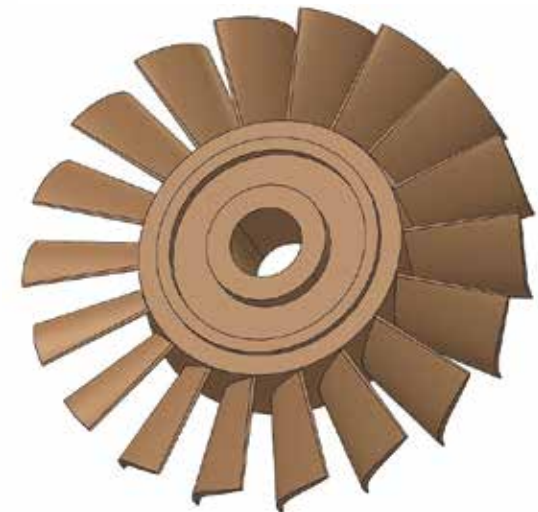
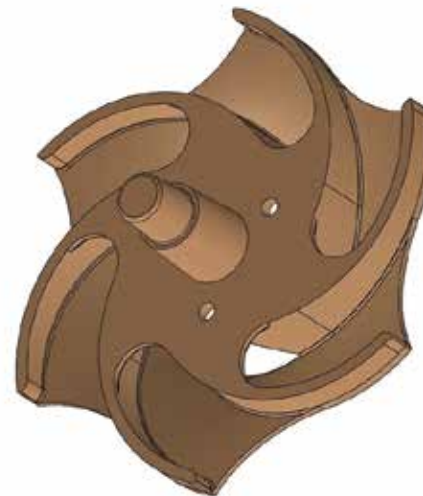
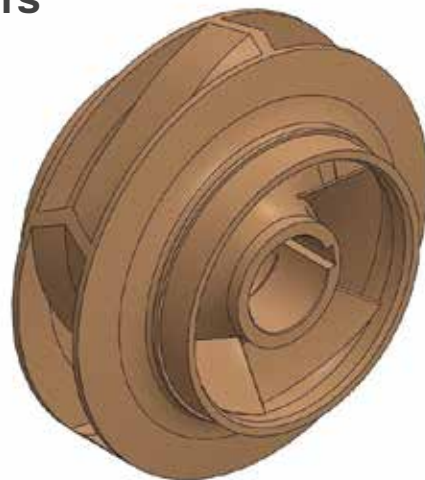

INVESTEMENT CASTING PARTS

Other Parts



ROCKER ARM

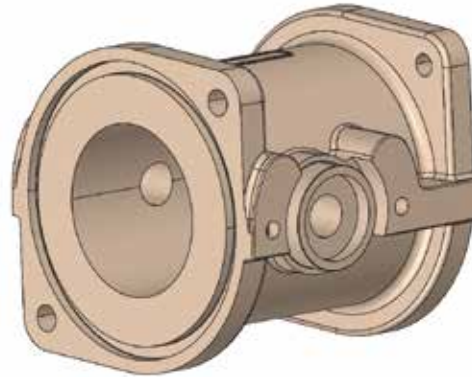

THROTTLE VALVE



AIR VALVE BODY



AIR VALAVE HOUSING



TRACTOR PART (VALVE)



FUEL PUMP HOUSING

INVESTMENT CASTING PARTS

Other Parts



GEAR BOX COVER



TRANSDUCER



VALAVE BODY

Material		International Standard
Steel		ASTM A351 & A 743 - Austenitic Stainless steel (CF3-304L, CF8-304, CF3M-316L, CF8M-316)
		ASTM A352 - LCA, LCB, LCC, CA6NM
		A 216 - WCA, WCB, WCC
Bronze		ASTM B584 - Silicon Bronze, Manganese Bronze, High-lead tin bronze
		ASTM B148 - Aluminum Bronze, Nickel Aluminum Bronze

FACTORY OFFICE:

SUHAIL FACTORY FOR METAL CASTINGS

P.O Box: 8839 Doha-Qatar

Phone: + 974 4427 5552

Fax: +974 4427 5554

info@suhailcastings.com

www.suhailcastings.com

